



# BEVERAGE-AIR

PO Box 5932, Spartanburg, SC 29304  
1-888-845-9800 Fax# 1-864-582-5083  
<http://www.Beverage-Air.com>

## Commercial Refrigeration Equipment General Specification

### ONE DOOR BOTTOM MOUNT—GLASS DOOR MERCHANTISER

Single section glass door merchandiser with lighted sign panel used for merchandising and storage of frozen food, frozen novelty items and cold product.

#### CABINET CONSTRUCTION

Heavy duty construction includes white coated steel interior and exterior. Choose from black or white exterior finish.

Foamed-in-place CFC and HCFC-free polyurethane insulation enhances the structural strength of the cabinet and helps increase energy efficiency.

Triple pane tempered glass doors on refrigerator models. Heated hinged triple pane tempered glass doors on freezer models. Magnetic door gaskets provide positive seal. Door provides automatic hold-open feature.

Three white epoxy coated steel shelves are standard.

Brightly lighted sign panel.

#### REFRIGERATION

Self-contained bottom mount refrigeration system. Expansion valve refrigerant control on freezer provides quick temperature pull down and reduces compressor run time—meaning reduced energy consumption. Includes automatic condensate disposal. Refrigerators utilize ozone friendly R134a refrigerant. Freezers utilize ozone friendly R404A refrigerant and feature automatic defrost.

Freezer product temperatures from -15°F to -5°F.  
Refrigerator product temperatures from 36°F to 38°F.

#### ELECTRICAL

Vertical interior lighting enhances product presentation.

Units wired at factory and ready for connection to a 115/60/1 phase, 15 amp dedicated outlet. 8' long cord and plug set included.

Item No. \_\_\_\_\_  
Quantity \_\_\_\_\_

## ONE DOOR BOTTOM MOUNT GLASS DOOR MERCHANTISERS REFRIGERATORS AND FREEZERS

MODELS:  
CFG24  
CRG24



CRG24



CFG24

#### SPECIAL FEATURES

- Vertical interior lighting
- Lighted sign panel



115/60/1  
NEMA-5-15P

#### ELECTRICAL CONNECTION

Units pre-wired at factory and include 8' long cord and plug set.

Available From:



\*Note: Not all markings may apply to all model variations.

Model Specified \_\_\_\_\_

Store# \_\_\_\_\_

Location \_\_\_\_\_

Quantity \_\_\_\_\_



**BEVERAGE-AIR**

**One Door, Bottom Mount Glass Door Merchandisers**

Models: CFG24, CRG24

MODEL	CFG24 FREEZER	CRG24 REFRIGERATOR
<b>EXTERNAL DIMENSIONAL DATA</b>		
Length Overall (inches)	26"	26"
Length Overall (mm)	660	660
Depth Overall (inches)	32"	32"
Depth Overall (mm)	813	813
Height Overall— (inches)	79 1/4"	79 1/4"
Height Overall— (mm)	2013	2013
Number of doors	1	1
Depth with Door Open 90 °	56 1/2"	56 1/2"
<b>INTERNAL DIMENSIONAL DATA</b>		
NET Capacity (cubic ft.)	18.61	18.61
NET Capacity (Liters)	527	527
Internal Length Overall (inches)	22"	22"
Internal Length Overall (mm)	559	559
Internal Depth Overall (inches)	27 1/2"	27 1/2"
Internal Depth Overall (mm)	699	699
Internal Height Overall—(inches)	59"	59"
Internal Height Overall—(mm)	1499	1499
Number of shelves	3	3
<b>ELECTRICAL DATA</b>		
Full Load Amperes 115/60/1	14.6	5.7
<b>ENERGY CONSUMPTION (KWH)</b>		
	15.05	6.45
<b>REFRIGERATION DATA</b>		
Horsepower	3/4	1/4
<b>WEIGHT DATA</b>		
Gross Weight (Crated lbs)	454	373
Gross Weight (Crated kg)	206	169

**PLAN VIEWS**

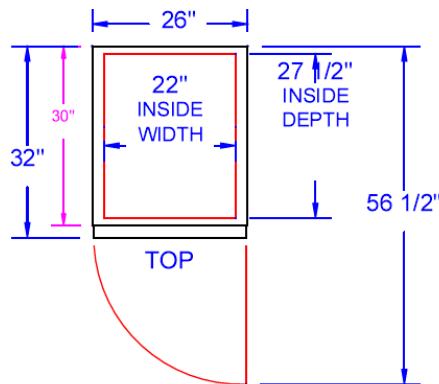
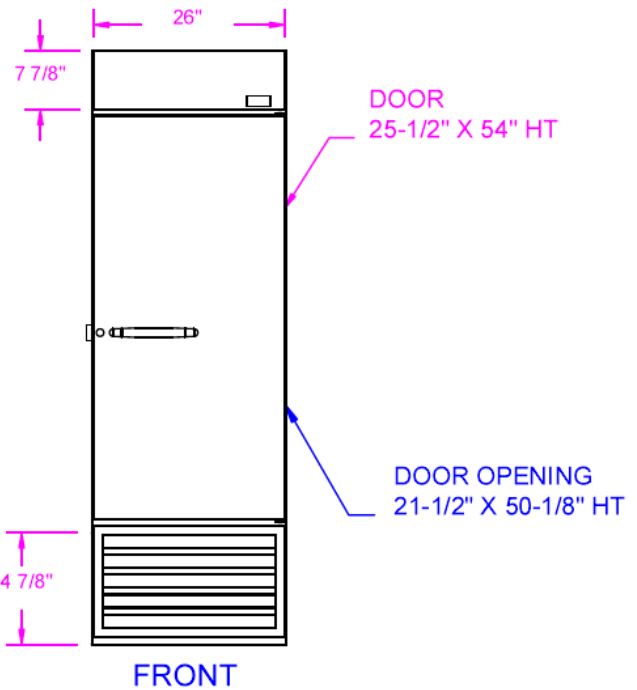
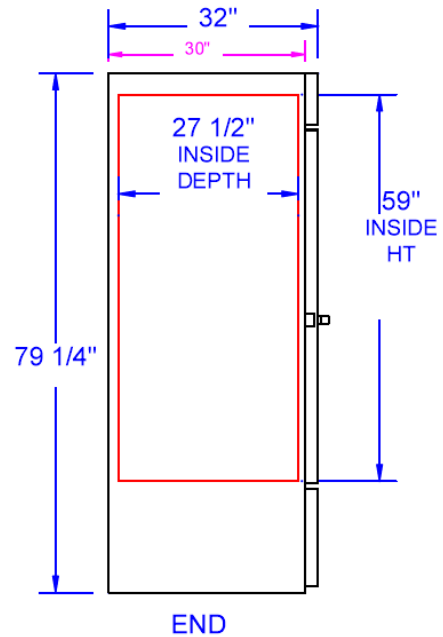

Note: Not all markings may apply to all model variations.

**BEVERAGE-AIR® CORPORATION**

700 Buffington Road • PO Box 5932 • Spartanburg, SC 29304 USA • (864) 582-8111 • Fax (864) 582-5083 • (888) 845-9800 • www.beverage-air.com

Specifications are subject to change without prior notice. 03/09